



## Neutral Pier Blade Signs

Roosevelt Field Mall – Dining District

### Dining District – Neutral Pier Blade Signs

This Project Bulletin provides detail and direction regarding Landlord Blade Sign Brackets provided to select Tenants in the Dining District.

### Tenant spaces required to comply with this criteria are as follows:

Space FB01 thru FB05 - Receive Zone 1 Blade Signs.

Space FB07 thru FB12 - Receive Zone 1 Blade Signs.

### Tenant spaces NOT REQUIRED to comply with this criteria are as follows:

FB06 and FB13 (End Cap Tenants) do not have LL provided Blade Signs.

FB14 thru FB17 (Food Island kiosks) do not have LL provided Blade signs.

Blade signage in Zone 1 shall be:

#### **Landlord:**

- Mounting hardware shall be installed on each side neutral pier/ demising wall, ready for Tenant provided Blade Sign Panel

#### **Tenant:**

- Shall fabricate 1" thick clear frosted acrylic panel, frost finish on both sides with flame polished edges. Overall panel size is 1'-2" high by 4'-8" wide.

Panel shall be installed by Tenant in Landlord provided mounting hardware.

- Sign is non-illuminated.
- Tenant DBA/logo shall fit within 8" high by 4'-3" wide area.
- DBA/logo type must be 1/2" thick acrylic dimensional letters chemically bonded flush to panel surface painted to match PMS 424 in a satin finish.
- DBA/Logo type must be applied to both sides of panel in the same manner; first apply logos in vinyl so that tape/ adhesive is not visible from other side of the clear panel.

Tenant or Tenant Sign Vendor shall contract directly with (DCL) Design Communications, LTD to fabricate panel at Tenant Expense.

*DESIGN COMMUNICATIONS LTD*

*Nafie O. Nafie, Project Manager*

*Phone 617-542-9620*

*Direct 857-284-5470*

[www.dclboston.com](http://www.dclboston.com)

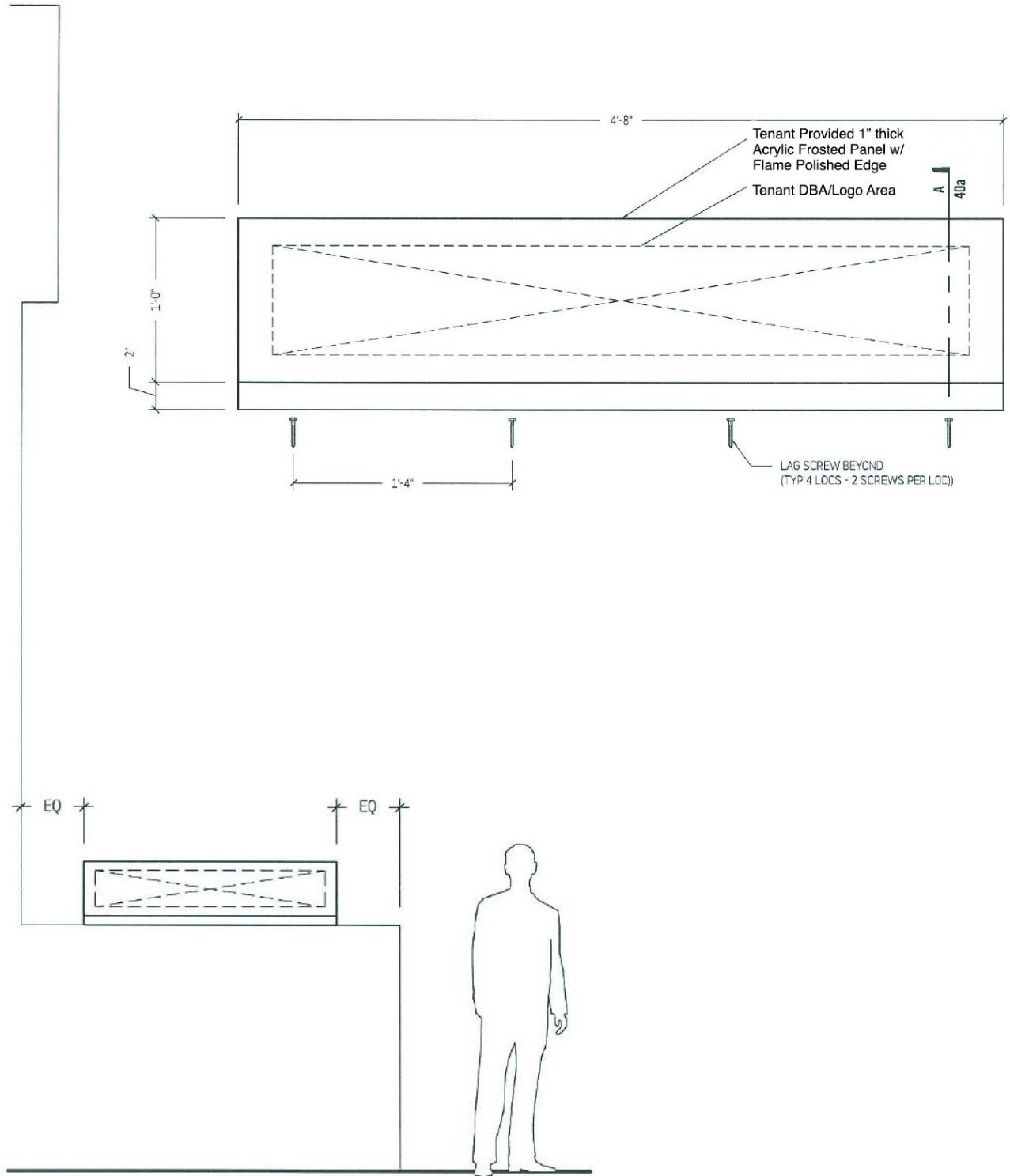

1 ELEVATION

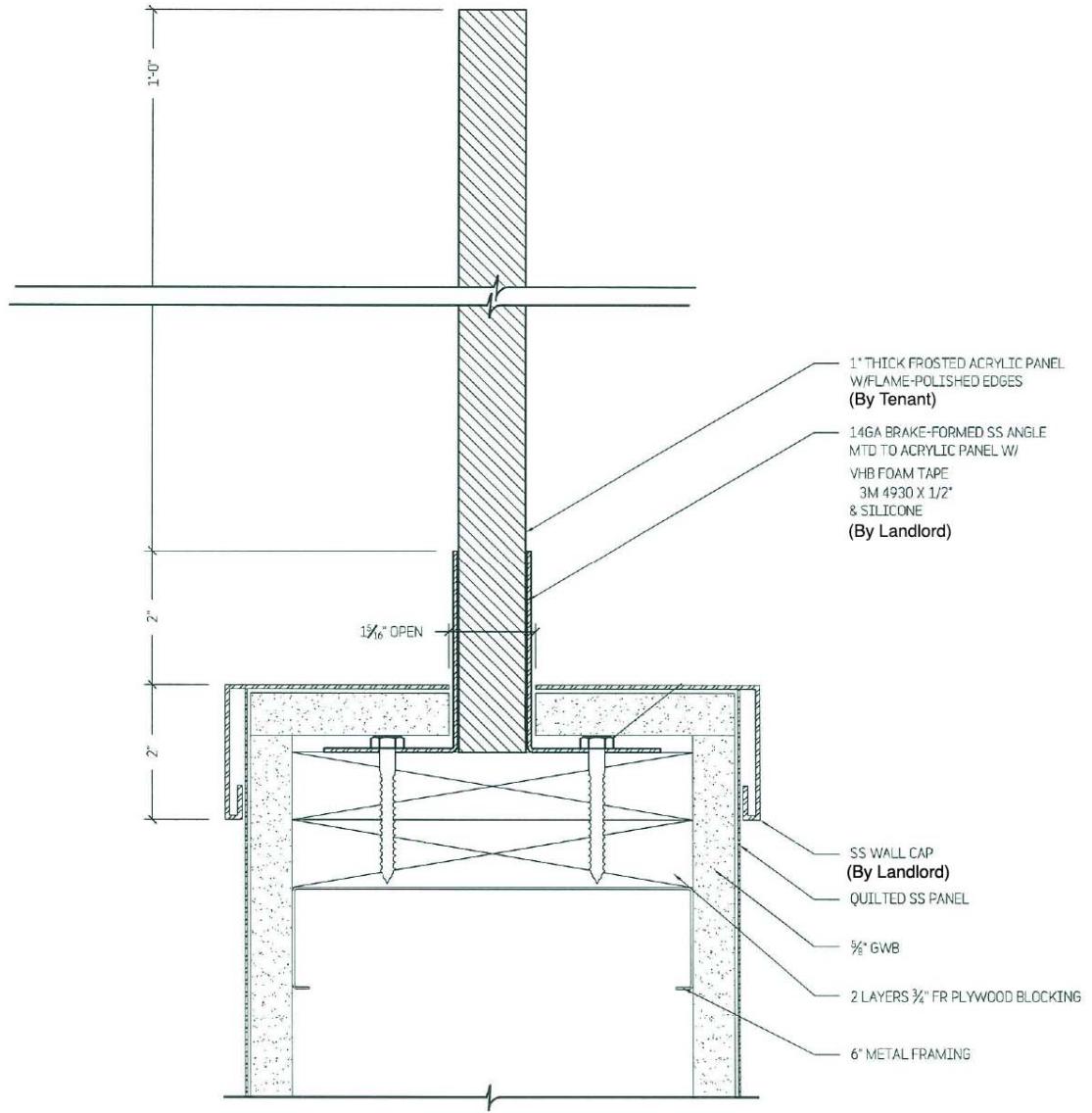

**A SECTION**